

# Electric 90° Quarter-Turn Actuator with Manual Override

PSF-Q-M

Manual Override

50 - 80 Nm  
Switching torque)<sup>1</sup>

16 / 20 / 30 s  
Operating Time/90°

Flange  
F05 + F07  
Positioner  
integrated

Modulating Actuator  
Class C  
acc. EN ISO 22153

Enclosure IP65  
EN 60529

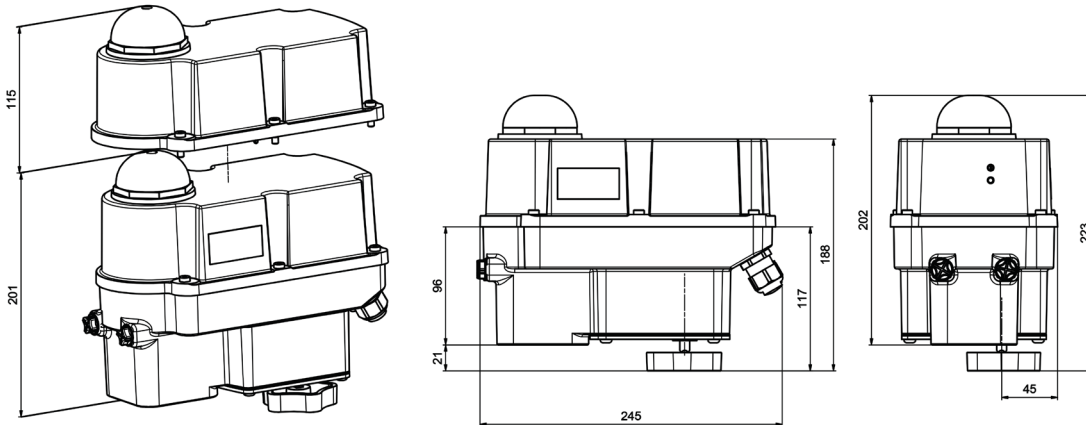

Approx. weight: 4.2 kg without accessories

Operating time / 90°	16 / 20 / 30 s (adjustable)		PSF-Q-M 50 Nm
Power Supply [V]	100-240 VAC 1~	24 VAC/DC	
Frequency [Hz]	50 - 60	50 - 60 / -	
Nominal Current [A]	0.1 - 0.2	0.8 / 0.5	
Maximum Current [A]	0.1 - 0.2	0.8 / 0.5	
Power Consumption ) <sup>2</sup> [W]	15	15 / 12	
Duty Cycle IEC 60034-1,8	S2 30 min / S4 50% ED - 1200c/h		

Operating time / 90°	16 / 20 / 30 s (adjustable)		PSF-Q-M 80 Nm
Power Supply [V]	100-240 VAC 1~	24 VAC/DC	
Frequency [Hz]	50 - 60	50 - 60 / -	
Nominal Current [A]	0.15 - 0.3	1.3 / 0.8	
Maximum Current [A]	0.15 - 0.3	1.3 / 0.8	
Power Consumption ) <sup>2</sup> [W]	23	23 / 18	
Duty Cycle IEC 60034-1,8	S2 30 min / S4 50% dc - 1200c/h		

Standard	Description	Standard Equipment
Ambient Temperature [°C]	-10 to +60 °C	
Motor Protection	electronic motor current monitoring with safety cut-off	
Overvoltage Category	II	
Set Value and Feedback	0-20 mA, 4-20 mA, 0-10 V, 2-10 V selectable	
Binary Control	24 - 230 VAC & 24 VDC for ON/OFF service	
Valve Positioner Function	integrated, deadband 0.6% of full signal range, shut-off minimum	
Automatic Start-up	Recognizing the end position(s) and autoscaling set and feedback values	
Internal Fault Monitoring	torque, set value, temperature, power supply	
Cable Glands	2 pcs. ISO M20 x 1.5 and 1 pcs. ISO M16 x 1.5	

)<sup>1</sup> = permissible average torque for a travel of 90° is 50% of the max. thrust

)<sup>2</sup> = at max. torque

Electrical Connection Plan

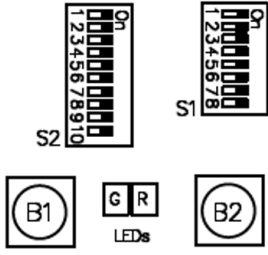

DIP Switches / Local Control Buttons

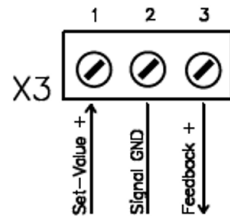

Analog Input / Output  
Galvanic isolated

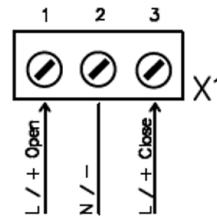

Binary input signals  
Galvanic isolated  
24 - 230VAC & 24 VDC

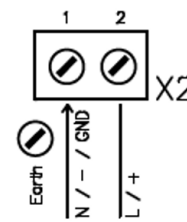

24VAC / DC Supply Power

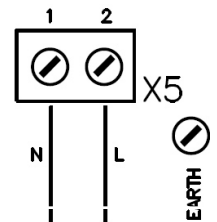

100-240 VAC Supply Power  
Wide Range Power Supply  
converter

Mounting Position

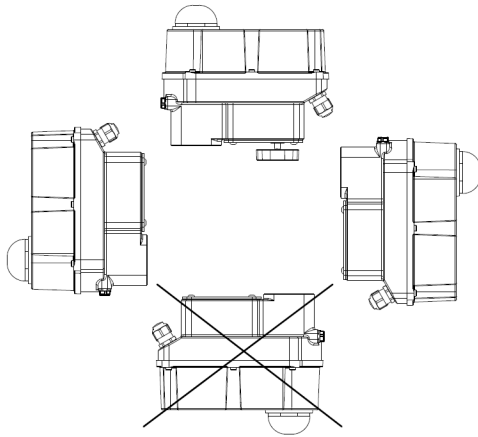

ISO Flange Dimensions

	F05	F07
M	M6	M8
B	9	12

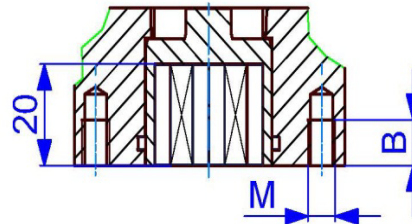

Double Square Drive

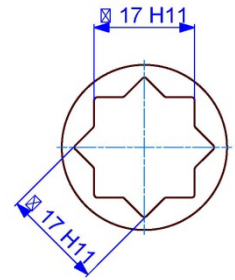

Please check the drive bushes datasheet for the available sizes!  
Other customized drive bushes on request!

Accessories/ Options		
Position Signal Relays		2 position signal relays with changeover contacts, calibrated automatically to angular travel 24 V to 230 V AC/DC @ 0.1 A – 1 A Switching point adjustable 0-100 % of the stroke using potentiometers
Heating Resistor	HR	Heating resistor to prevent condensation
Wide Range Power Supply		100 - 240 VAC 1~
Increased Enclosure	IP	Increase of enclosure to IP67

For more information and accessories, please visit our website [www.ps-automation.com](http://www.ps-automation.com)!

Subject to changes!